



## Children's MultiMic quick pairing guide

Instructions on how to pair your child's MultiMic to their hearing aid in order to stream sound wirelessly.

### MultiMic parts

1. Power button
2. LED indicator
3. Microphone
4. Microphone
5. Volume up
6. Volume down
7. Mute
8. Pairing button

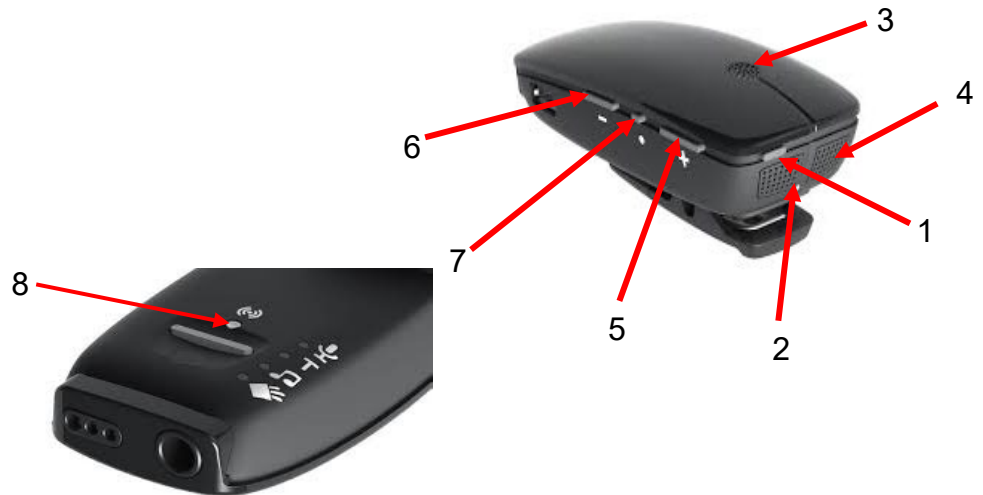

### Instructions

Please see page 10 of the manufacturers guide supplied with the MultiMic regarding charging and precautions. Once the MultiMic is fully charged it can be paired to your child's hearing aid.

1. Turn your child's hearing aid **OFF** by opening the battery compartment door (see the Hearing Aid information booklet for further information on battery safety).
2. Press and hold the power button (1) the MultiMic for 1.5 seconds to turn the MultiMic on. The LED indicator (2) will blink green every few seconds
3. With the tip of a pen, gently press the pairing button (8) on the back of the MultiMic. The LED indicator will blink orange every 2 seconds to indicate that the MultiMic is in pairing mode (*note: the MultiMic will automatically exit pairing mode if the next step is not completed within 20 seconds*).

While the MultiMic is in pairing mode, turn the hearing aid **ON** by closing the battery compartment of the hearing aid. If pairing has been successful, the LED indicator (2) will stay a solid orange colour for 3 seconds. If the hearing aid is in your ear while being paired, you will hear an audible melody. This indicate that pairing has been successful. If not, press the hearing aid programming button down for 3 seconds until the melody is heard.

Please refer to the manufacturers guide and videos on the resound website

<https://www.resound.com/en-gb/hearing-aids/accessories/multi-mic> for further information about how to pair and use your MultiMic, along with important safety information.

## MultiMic streaming guide

Once your MultiMic has been successfully paired with your child's hearing aid they will be able to use it to stream sound wirelessly to their hearing aid.

### To start streaming sound from the MultiMic either:

- Get your child to press and hold the programme button on the back of their hearing aid for 3 seconds. If the hearing aid is in their ear they should hear an audible melody to indicate that it is connected to the MultiMic.
- Otherwise you / teacher can use the listening apparatus from the child's hearing aid care kit and you can press and hold the programme button on the back of the child's hearing aid for 3 seconds. You should then be able to hear the audible melody through the listening apparatus to indicate that the hearing aid is connected to the MultiMic.

### To stop streaming sound from the MultiMic:

- Press the programme button on the back of your hearing aid once.
- Turn the hearing aid off.

## Best positioning of the MultiMic

Please note that the MultiMic must be within 10-40cm of the sound that your child wishes to have streamed to their hearing aid. This will likely be their teacher in a school setting.

The MultiMic must be clipped on the teacher's / speaker's lapel, or worn around the teacher's / speaker's neck, using the lanyard that is supplied with the device. The MultiMic must be placed in the upright position with the microphones (3, 4) pointing upwards towards the teacher's / speaker's mouth. The teacher / speaker will need to ensure that the microphones are not covered by clothing or placed against their chest.

Should the child want to use the MultiMic in a group scenario, place the MultiMic horizontally on a flat surface (i.e. on a table) in the middle of the group or close to the people that they wish to hear. Ensure that the microphones (3, 4) are NOT facing down on the flat surface.

## Locking the battery compartment on your child's hearing aid

Your audiologist will have installed a Left /Right side indicator in your hearing aid. This indicator can be used to lock the battery door. Once locked, the hearing aid can only be turned off once the hearing aid is unlocked again.

### To lock the battery door:

1. Close the battery door.
2. Using the battery door locking tool (Light Blue), slide the coloured marker to the right.

### To unlock the battery door:

3. Slide the coloured marker to the left.

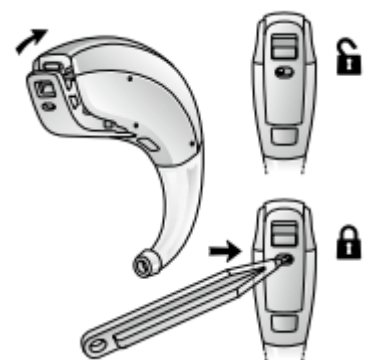

## Contact us

Audiology Department, Tel: 0118 322 7238 or Email: [audiology.royalberkshire@nhs.net](mailto:audiology.royalberkshire@nhs.net)

**Please ask if you need this information in another language or format.**

Compassionate

Aspirational

Resourceful

Excellent